

## Jacketed Low Pressure Infrared Emitter



**TOSHIBA** Jacketed Low Pressure infrared emitters are specially designed for food warming application.

Fig.1 shows how **TOSHIBA** infrared emitters efficiently generate more Infrared Heat Energy but less visible light than classical lighting emitters. Those are not only Low Pressure infrared emitter, but also additionally jacketed by 20mm dia. clear quartz sleeve :

- > For anti-scattering protection against quartz piece by accidental break of heater inside
- > To avoid chemical attacks over heater tubes to maintain good performance
- > To protect the infrared emitters from unexpected thermal shock such as splashed water or foods

The protection by clear quartz sleeve more securely ensures long life as well because of no direct contamination on infrared emitter inside from splashed sodium contained in foods. When such splashed sodium goes directly onto infrared emitter without protection being operated at high temperature, devitrification phenomenon is caused on quartz tube glass. Devitrification deteriorates not only quality of quartz over time, but also lifetime of infrared emitter itself.

**TOSHIBA** Jacketed Low Pressure infrared emitters protected by clear quartz sleeve therefore bring benefits of ;

- > \* More secured against accidental thermal shock
- > \* More durable against devitrification and mechanical shock
- > Warming foods or objects and the air in between
- > Low maintenance and long life 5000h on average
- > No warm-up time required, switched on-off within a second
- > Silent and odorless

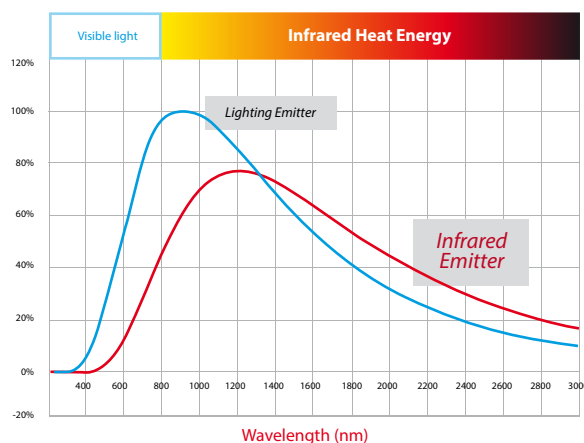

**TOSHIBA** jacketed Low Pressure infrared emitters are therefore the best suited for both warming and displaying in catering service operation.



**Benefits & Features**



# Jacketed Low Pressure **Infrared Emitter**

## Type 1

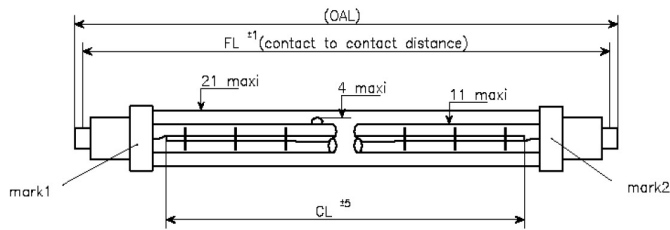

Base dimensions for Type 1 (R7s contact)

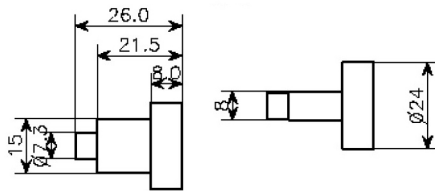

## Type 2

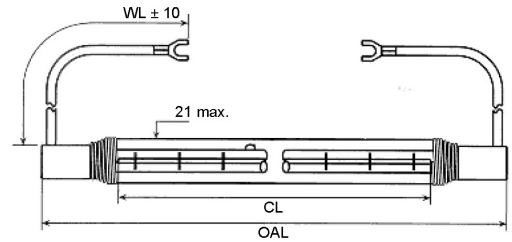

Base dimensions for Type 2

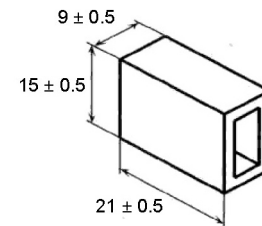

## Part list

Part code	Watts (W)	Volts (V)	Drawing	Wire length WL (mm)	Overall length OAL (mm)	Fixation length FL (mm)	Heating length CL (mm)	Burning position	Ave. Life
JHDS 230V 300W 60 VJH	300	230-240	Type 1	-	(118)	114.2 ± 1	60 ± 5	Horizontale	5000
JHDS 240V 300W 160 VJH	300	230-240	Type 1	-	(220)	216 ± 1	160 ± 5	Horizontale	5000
JHDS 240V 300W 160 BH	300	230-240	Type 2	200 ± 10	217 ± 2	-	160 ± 5	Horizontale	5000
JHDS 240V 500W 160 VJH	500	230-240	Type 1	-	(220)	216 ± 1	160 ± 5	Horizontale	5000
JHDS 240V 500W 160 BH	500	230-240	Type 2	200 ± 10	217 ± 2	-	160 ± 5	Horizontale	5000
JHDS 235V 1000W 272 VJH	1000	230-240	Type 1	-	(350)	346 ± 1.5	272 ± 5	Horizontale	5000
JHDS 235V 1000W 272 BH	1000	230-240	Type 2	200 ± 10	353 ± 2	-	272 ± 5	Horizontale	5000

Content to change without notice

Connect to :  
[www.toshiba-lighting.com](http://www.toshiba-lighting.com)

Contact us :  
 TOSHIBA LIGHTING PRODUCTS (France)  
 42 Rue St Dizier  
 54000 Nancy  
 Phone : + 33 (0) 3 83 39 00 83